

## MEDICAL COVERAGE under Medi-Cal

**Medi-Cal provides** medical, dental



and vision care for eligible children, low-income adults, and elderly persons. The

Medi-Cal program also includes services such as Long Term Care and Assisted Living Board & Care, to ensure the health care needs of low-income and elderly persons are met. The HRA determines eligibility for Medi-Cal.

**Healthy Families** Provides medical care for children who do not qualify for Medi-Cal and have no other medical insurance.

### County Medical Services Program (CMSP)

provides medical care.  
for indigent adults.



## What Services does Medi-Cal cover?

Medi-Cal is health insurance.

Once you have been approved for Medi-Cal, you are eligible for services covered by Medi-Cal. Butte County Department of Social Welfare can help connect you to a range of services such as:

Doctor's Visits

Dental

Prescriptions

Hospitalization

Psychologist visits (counselor)

Psychiatric visits (doctor)

Nursing homes & in-home support

Substance abuse treatment

X-Rays

And more

Do you and your  
family need FREE or  
Low Cost Medical  
Insurance

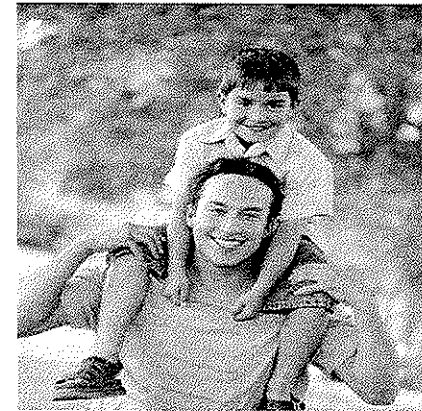

## MEDI-CAL TODAY



Siskiyou County  
Department of  
Human Services

530-841-2700

## Who May get Medi-Cal coverage?

- Families where a parent is absent, unemployed, or disabled.
- Children under the age of 21 
- Pregnant Women
- Undocumented or temporary residents may qualify for full or limited benefits.
- People who receive Supplemental Security Income/State Supplementary Program (SSI/SSP)
- Or Temporary assistance for needy Families (TANF)
- People 65 years or older, blind, or disabled 
- People who are in a long term care facility
- Families with higher income can also qualify, You may have to pay a share of your medical costs.

## Getting Medi-Cal is Easier then you think!

### How do I apply?

Pick up or call for a mail-in application from the Medi-Cal eligibility office : **530-934-6514** OR



ON-LINE applications can be obtained at:  
[www.dhs.ca.gov](http://www.dhs.ca.gov)

Bring your application to one of the following locations listed in this brochure for information on how to apply for

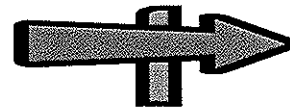
Medi-Cal



Make an appointment and bring the following information with you.

- Identification 
- Bank Statements for month in which you are applying
- Proof of immigration status 
- Proof of income such as (check stubs, unemployment, pension, etc.)

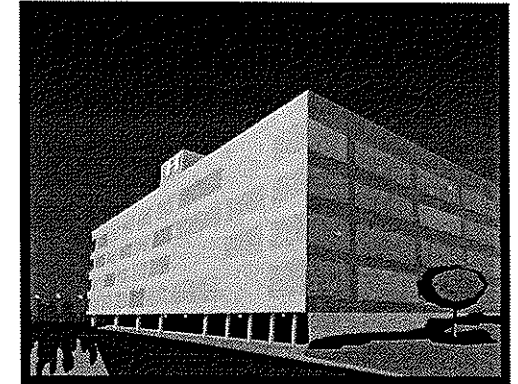

**Siskiyou County  
Department of  
Human Services  
818 S. Main Street  
Yreka, CA 96097  
560-841-2700**

